

- All dimensions are in metres unless otherwise noted.
- All arboricultural work performed on trees such as pruning of branches and roots shall be conducted by an ISA Certified Arborist.
- Prune and mitigate limbs and roots damaged by construction work in accordance with ANSI A300 (Part 1) - 2008 Pruning and the Best Management Practices companion publication (revised 2008).
- Tree Protection Fence to be erected prior to the commencement of any construction or grading, and maintained throughout the duration of the work.
- Tree Protection Zone is delimited by Tree Protection Fence shown on the drawings.
- No construction or activities including the following to occur within Tree Protection Zone: excavation, equipment parking or access, storage of supplies, topsoil or fill, and refueling.
- Tree removals (if required) will be undertaken in compliance with the Migratory Birds Convention Act. Efforts will be made to remove vegetation outside the General Nesting period (April 1 - Aug 31) for regions C1 and C2 of Ontario. In the event vegetation must be removed within the General Nesting Period, a qualified avian biologist is to review the site prior to removal to ensure compliance with the Migratory Birds Convention Act.
- Any soils and vegetation within tree protection zone damaged by the Contractor shall be restored to the satisfaction of the Municipality by the Contractor at no additional cost to the Owner.

CONSTRUCTION WITHIN MINIMUM TREE PROTECTION ZONE

- An ISA Certified Arborist must be present on site during construction activities within MTPZ to confirm and/or modify mitigation measures for trees to be preserved.
- Use trenchless methods (e.g. horizontal directional drilling) to install underground services (e.g. sanitary sewers and water lines) within Minimum Tree Protection Zones.

FINISH GRADING WITHIN TREE PROTECTION ZONES

Where finish grading of cuts and fills, and including swales occurs within tree protection zones, the following steps are required.

Grade Cut:

- Excavate by hand or Air-Spade technology to a maximum depth of 100mm.
- Roots encountered are to be assessed by the Project Arborist to determine the extent of roots to be pruned. Based on findings, other treatments may be required (e.g. crown reduction, tree removal), and which may require approval from the City.
- Based on root findings, local, minor adjustments to grading within the tree protection zone may be required based on field consultation between the Project Arborist and Project Engineer.
- No access by heavy equipment into tree protection zone is permitted. Fine grading to be carried out using light equipment and/or by hand.

Grade Fill:

- Add topsoil to meet grade requirements to a maximum of 150mm.
- No topsoil to be added onto trunk base or above-ground section of trunk base flare.
- Maintain positive drainage away from trunk base.
- Based on local conditions (e.g. surface drainage), local, minor adjustments to grading within the tree protection zone may be required based on field consultation between the Project Arborist and Project Engineer.

1 TREE PRESERVATION NOTES
 TPP1 N.T.S.

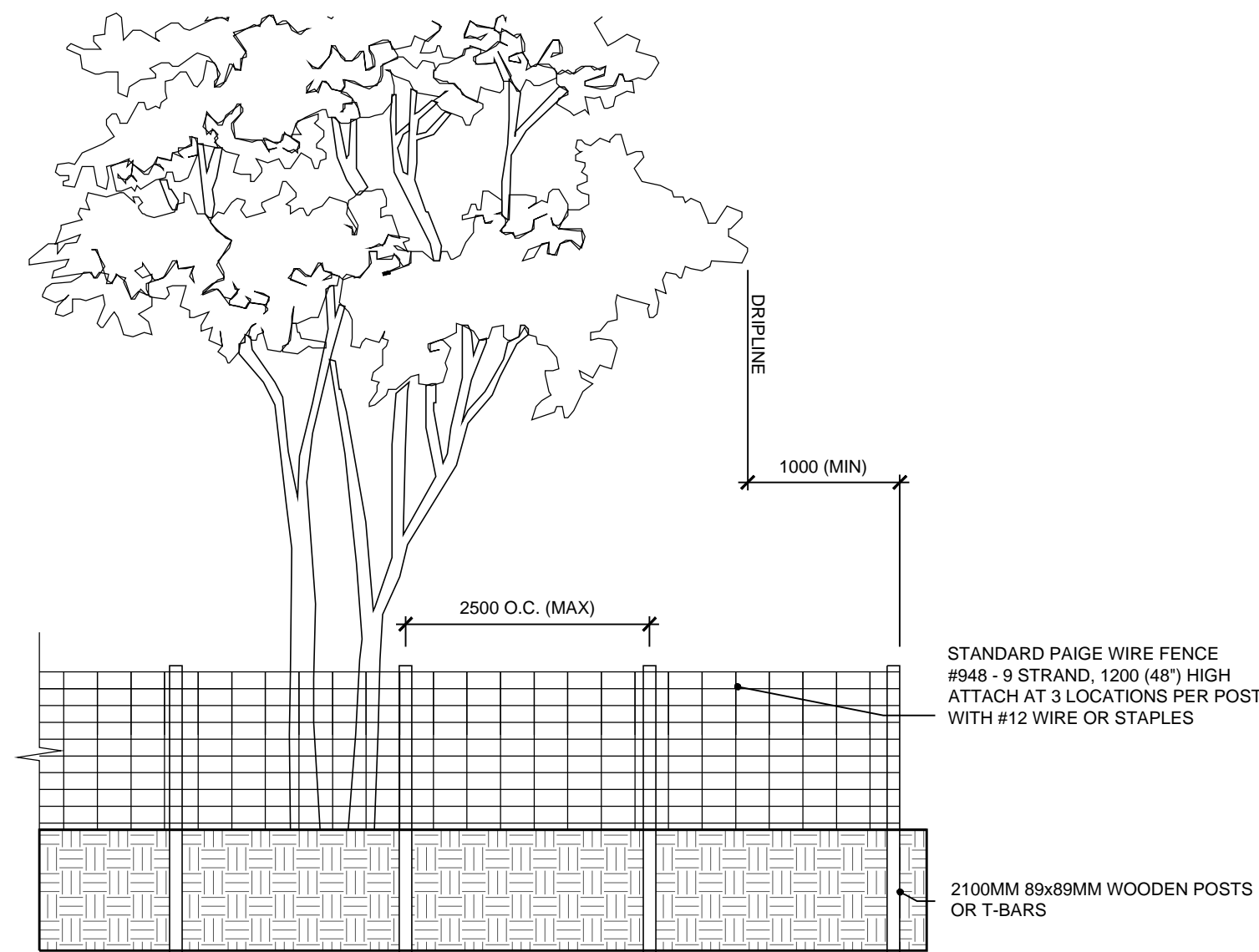

2 TYPICAL TREE PROTECTION FENCE
 TPP1 N.T.S.

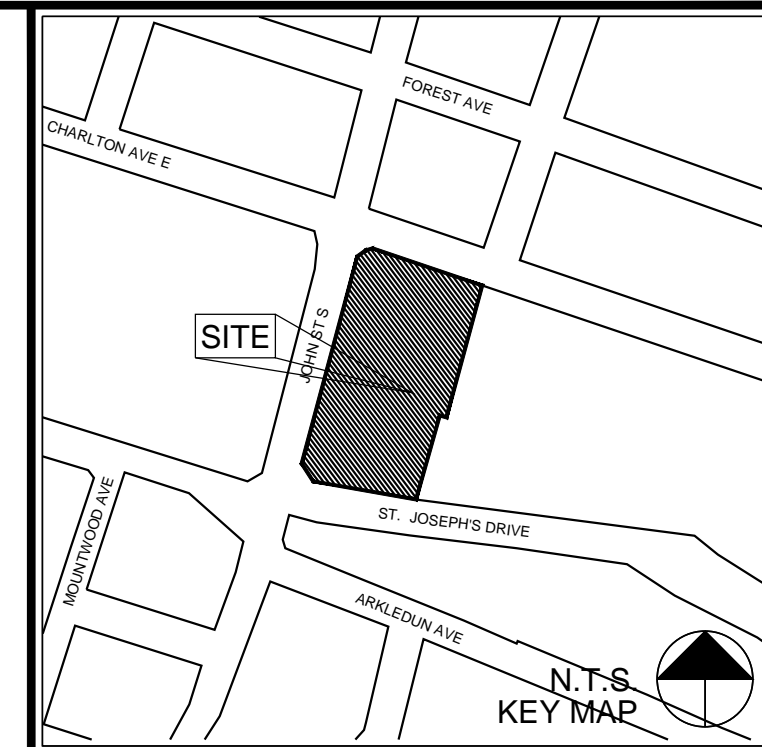
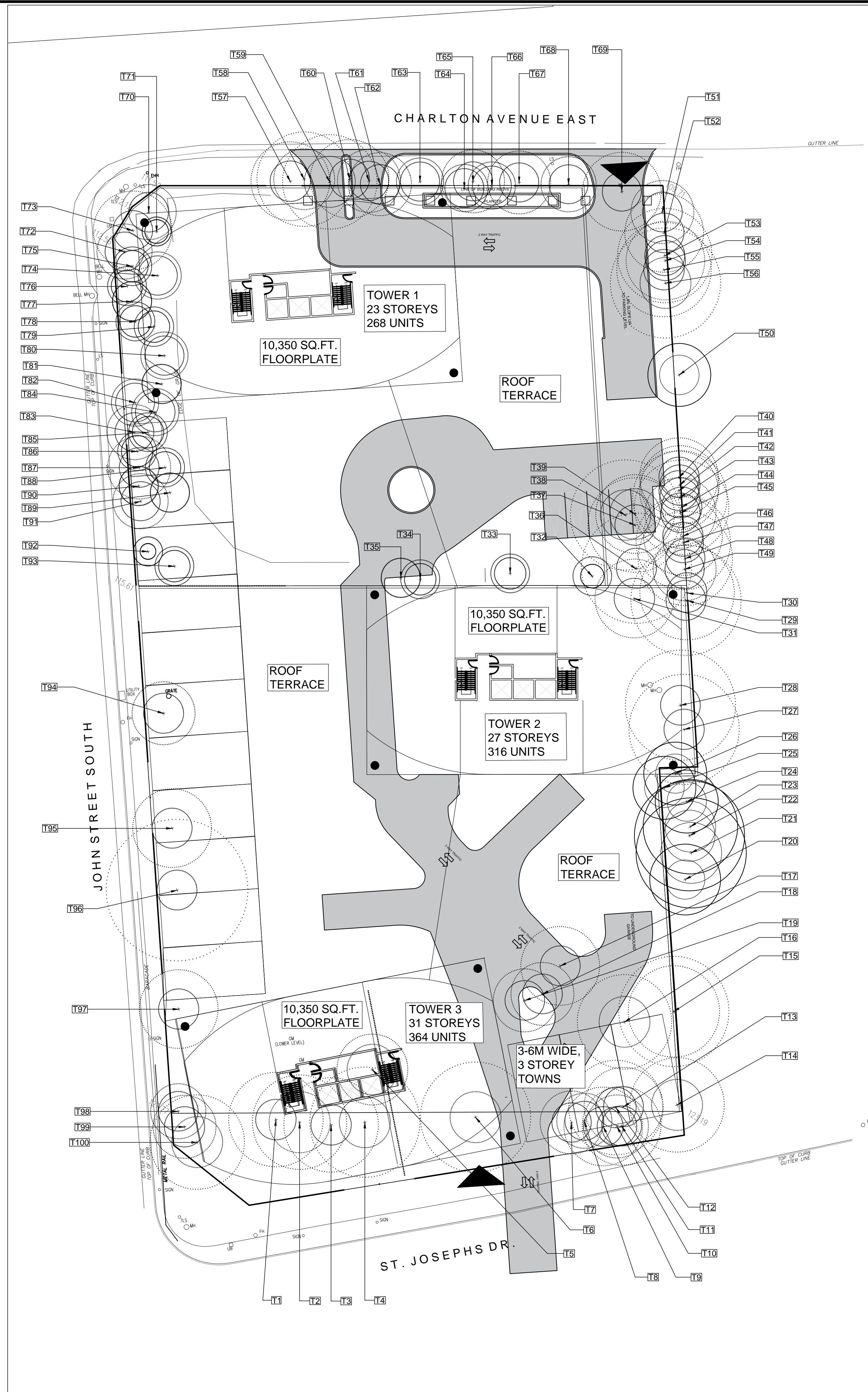

- LEGEND:**
- EXISTING TREE
ID NUMBER / CIRCLE ILLUSTRATES
APPROXIMATE CROWN RESERVE
 - PRESERVE TREE
TREE HAS MODERATE TO HIGH BIOLOGICAL
HEALTH AND/OR STRUCTURAL CONDITION AND
CAN BE INCORPORATED INTO THE PROPOSED
DEVELOPMENT
 - REMOVE TREE
TREE HAS LOW BIOLOGICAL HEALTH AND/OR
STRUCTURAL CONDITION
 - REMOVE TREE
TREE IS IN CONFLICT WITH PROPOSED
DEVELOPMENT
 - REMOVE TREE
TREE HAS LOW BIOLOGICAL HEALTH AND/OR
STRUCTURAL CONDITION AND IS IN CONFLICT
WITH PROPOSED DEVELOPMENT
 - REMOVE TREE
TREE IS DEAD

INFORMATION SOURCES

- Topo Survey dated July 23, 2013 prepared by Ashenhurst Nouwens Limited. Tel 905.529.6316
- Concept Plan dated August 3, 2017 prepared by Urban Solutions Inc. Tel. 905.546.1087
- Tree Information collected by Aboud & Associates on August 21, 2017.

No.	Description	By	Date
1	FIRST SUBMISSION OF TPP	JD	15 DEC-17

REVISIONS: All previous issues of this drawing are superseded

ABOUT & ASSOCIATES INC.
 Consulting Arborists • Ecologists • Landscape Architects
 190 Niclén Road, Guelph, Ontario, Canada, N1H 7L5
 T: 519.822.6839 • F: 519.822.4052 • info@aboutng.com • www.aboutng.com

Title:
TREE PRESERVATION PLAN
 Project:
299-307 JOHN STREET SOUTH & 97 ST. JOSEPH DRIVE
 CITY OF HAMILTON CLIENT

Date: DECEMBER 2017
 Project: AA17-114A
 Scale: 1:300
 Designer: JD
 Drawn: NH
 Checked: JD

Drawing No:
TPP1

Tree No.	Tree Species	DBH (cm) 1.3	Minimum Tree Protection Zone (m) (canopy)	Crown Spread (m)	Condition Rating	Location: Private, Other, Municipal, Shared	Rec. Action: Preserve	Rec. Action: Remove	Rec. Action: Develop	Final Recommendation	Comments / Observations
1	Acer platanoides Norway Maple	34	2.4	12	Fair	P	P	R	RD	Decay in trunk suspected	
2	Acer platanoides Norway Maple	56	3.6	12	Good	P	P	R	RD		
3	Acer platanoides Norway Maple	32	2.4	12	Fair	P	P	R	RD		
4	Acer platanoides Norway Maple	47	3.0	14	Fair	P	P	R	RD		
5	Tilia x Euthora Crimean Linden	41	3.0	9	Fair	P	P	R	RD	Codominant leaders	
6	Acer platanoides Norway Maple	48	3.0	14	Good	P	P	R	RD		
7	Acer platanoides Norway Maple	20	2.4	8	Good	P	P	R	RD		
8	Acer platanoides Norway Maple	14	2.4	7	Good	P	P	R	RD		
9	Morus alba White Mulberry	24	2.4	10	Good	P	P	R	RD	Weeping trunk wound (minor)	
10	Ailanthus altissima Tree Of Heaven	23	2.4	8	Fair	P	P	R	RD	Past branch failure (minor)	
11	Ailanthus altissima Tree Of Heaven	27	2.4	10	Good	P	P	R	RD		
12	Ailanthus altissima Tree Of Heaven	34	2.4	12	Good	P	P	R	RD		
13	Ailanthus altissima Tree Of Heaven	27	2.4	10	Good	P	P	R	RD		
14	Acer platanoides Norway Maple	47	3.0	12	Fair	P	P	R	RD	Codominant stems	
15	Ailanthus altissima Tree Of Heaven	81	5.4	14	Fair	P	P	R	RD	Growing around fence	
16	Juglans nigra Black Walnut	45	3.0	12	Fair	P	P	R	RD	Trunk wound (moderate); Decay (minor)	
17	Acer platanoides Norway Maple	27	2.4	10	Good	P	P	R	RD		
18	Betula papyrifera Paper Birch	25	2.4	8	Good	P	P	R	RD		
19	Acer platanoides Norway Maple	23	2.4	8	Good	P	P	R	RD		
20	Ailanthus altissima Tree Of Heaven	19	2.4	9	Good	O	P	P	P		
21	Ailanthus altissima Tree Of Heaven	54	3.6	14	Fair	O	P	P	P	Codominant leaders	
22	Morus alba White Mulberry	49	3.0	14	Fair	O	P	P	P	Codominant stems	
23	Ailanthus altissima Tree Of Heaven	44	3.0	12	Fair	O	P	P	P	Codominant leaders	
24	Acer platanoides Norway Maple	20	2.4	8	Fair	O	P	P	P	Codominant stems	
25	Ailanthus altissima Tree Of Heaven	23	2.4	8	Good	O	P	P	P		
26	Ailanthus altissima Tree Of Heaven	18	2.4	8	Good	O	P	P	P		
27	Morus alba White Mulberry	31	2.4	14	Fair	P	P	R	RD	Trunk lean (severe)	
28	Morus alba White Mulberry	24	2.4	14	Fair	P	P	R	RD	Codominant stems; Trunk lean (severe)	
29	Ailanthus altissima Tree Of Heaven	28	2.4	14	Good	P	P	R	RD		
30	Ailanthus altissima Tree Of Heaven	23	2.4	12	Good	P	P	R	RD		
31	Ailanthus altissima Tree Of Heaven	33	2.4	10	Fair	P	P	R	RD	Unbalanced crown (severe)	
32	Thuja occidentalis Eastern White Cedar	11	2.4	3	Good	P	P	R	RD		
33	Thuja occidentalis Eastern White Cedar	13	2.4	4	Good	P	P	R	RD		
34	Thuja occidentalis Eastern White Cedar	14	2.4	4	Fair	P	P	R	RD		
35	Thuja occidentalis Eastern White Cedar	14	2.4	5	Fair	P	P	R	RD		
36	Ailanthus altissima Tree Of Heaven	28	2.4	14	Good	P	P	R	RD		
37	Ailanthus altissima Tree Of Heaven	34	2.4	12	Fair	P	P	R	RD		
38	Ailanthus altissima Tree Of Heaven	41	3.0	14	Good	P	P	R	RD		
39	Ailanthus altissima Tree Of Heaven	43	3.0	10	Fair	P	P	R	RD	Codominant leaders; Crown dieback (moderate)	
40	Ailanthus altissima Tree Of Heaven	31	2.4	10	Good	P	P	R	RD		
41	Ailanthus altissima Tree Of Heaven	31	2.4	10	Fair	P	P	R	RD	Growing through fence	
42	Ailanthus altissima Tree Of Heaven	26	2.4	10	Good	P	P	R	RD		
43	Ailanthus altissima Tree Of Heaven	30	2.4	12	Fair	P	P	R	RD	Growing through fence	
44	Ailanthus altissima Tree Of Heaven	34	2.4	12	Good	P	P	R	RD		
45	Ailanthus altissima Tree Of Heaven	20	2.4	9	Good	P	P	R	RD		
46	Ailanthus altissima Tree Of Heaven	31	2.4	10	Good	P	P	R	RD		
47	Ailanthus altissima Tree Of Heaven	33	2.4	12	Good	P	P	R	RD		
48	Ailanthus altissima Tree Of Heaven	19	2.4	12	Poor	P	R	R	RCD	Growing around fence post	
49	Ailanthus altissima Tree Of Heaven	19	2.4	8	Good	P	P	R	RD		
50	Pinus nigra Austrian Pine	23	2.4	8	Good	P	P	R	P	Offsite, location estimated	
51	Ailanthus altissima Tree Of Heaven	25	2.4	8	Fair	P	P	R	RD		
52	Ailanthus altissima Tree Of Heaven	23	2.4	10	Poor	P	R	R	RCD	Growing through fence at two points in trunk	
53	Ailanthus altissima Tree Of Heaven	28	2.4	12	Good	P	P	R	RD		
54	Ailanthus altissima Tree Of Heaven	28	2.4	10	Good	P	P	R	RD		
55	Ailanthus altissima Tree Of Heaven	34	2.4	12	Good	P	P	R	RD		
56	Ailanthus altissima Tree Of Heaven	47	3.0	14	Fair	P	P	R	RD	Codominant stems	
57	Ailanthus altissima Tree Of Heaven	34	2.4	10	Fair	M	P	R	RD	Smaller stem is acer platanoides	
58	Ailanthus altissima Tree Of Heaven	54	3.6	12	Fair	M	P	R	RD	Growing through fence	
59	Ailanthus altissima Tree Of Heaven	48	3.0	12	Good	M	P	R	RD		
60	Ailanthus altissima Tree Of Heaven	24	2.4	10	Poor	M	R	R	RCD	Crown dieback (severe)	
61	Ailanthus altissima Tree Of Heaven	20	2.4	8	Poor	M	R	R	RCD	Crown dieback (severe)	
62	Ailanthus altissima Tree Of Heaven	17	2.4	8	Poor	M	R	R	RCD	Crown dieback (severe)	
63	Ailanthus altissima Tree Of Heaven	16	2.4	6	Good	M	P	R	RD		
64	Acer platanoides Norway Maple	14	2.4	6	Poor	P	R	R	RCD	Growing through fence	
65	Acer platanoides Norway Maple	15	2.4	8	Fair	M	P	R	RD		
66	Acer platanoides Norway Maple	15	2.4	6	Fair	P	P	R	RD		
67	Acer platanoides Norway Maple	17	2.4	8	Good	M	P	R	RD		

Tree No.	Tree Species	DBH (cm) 1.3	Minimum Tree Protection Zone (m) (canopy)	Crown Spread (m)	Condition Rating	Location: Private, Other, Municipal, Shared	Rec. Action: Preserve	Rec. Action: Remove	Rec. Action: Develop	Final Recommendation	Comments / Observations
68	Acer platanoides Norway Maple	14	2.4	7	Fair	M	P	R	RD		
69	Ailanthus altissima Tree Of Heaven	14	2.4	10	Fair	P	P	R	RD	Coppice growth from removed tree	
70	Acer platanoides Norway Maple	24	2.4	7	Good	P	P	R	RD		
71	Picea pungens 'Gauca' Colorado Blue Spruce	8	1.8	3	Fair	P	P	R	RD		
72	Acer platanoides Norway Maple	15	2.4	7	Fair	P	P	R	RD		
73	Acer platanoides Norway Maple	24	2.4	10	Fair	P	P	R	RD	Codominant leaders	
74	Picea pungens 'Gauca' Colorado Blue Spruce	19	2.4	6	Good	P	P	R	RD		
75	Picea pungens 'Gauca' Colorado Blue Spruce	12	2.4	4	Poor	P	R	R	RCD		
76	Acer platanoides Norway Maple	13	2.4	4	Poor	P	R	R	RCD		
77	Picea pungens 'Gauca' Colorado Blue Spruce	14	2.4	5	Fair	P	P	R	RD		
78	Picea sp Spruce	14	2.4	4	Dead	P	R	R	RCD		
79	Picea pungens 'Gauca' Colorado Blue Spruce	21	2.4	4	Poor	P	R	R	RCD	Crown dieback (severe)	
80	Picea pungens 'Gauca' Colorado Blue Spruce	18	2.4	6	Poor	P	R	R	RCD		
81	Picea pungens 'Gauca' Colorado Blue Spruce	15	2.4	5	Fair	P	P	R	RD		
82	Acer platanoides Norway Maple	14	2.4	6	Good	P	P	R	RD		
83	Acer platanoides Norway Maple	12	2.4	7	Fair	P	P	R	RD		
84	Picea pungens 'Gauca' Colorado Blue Spruce	22	2.4	6	Good	P	P	R	RD		
85	Picea pungens 'Gauca' Colorado Blue Spruce	11	2.4	4	Fair	P	P	R	RD		
86	Picea pungens 'Gauca' Colorado Blue Spruce	13	2.4	4	Good	P	P	R	RD		
87	Acer platanoides Norway Maple	24	2.4	8	Good	P	P	R	RD		
88	Picea pungens 'Gauca' Colorado Blue Spruce	16	2.4	4	Good	P	P	R	RD		
89	Picea pungens 'Gauca' Colorado Blue Spruce	14	2.4	5	Good	P	P	R	RD		
90	Acer platanoides Norway Maple	14	2.4	5	Poor	P	R	R	RCD		
91	Acer platanoides Norway Maple	17	2.4	7	Fair	P	P	R	RD		
92	Picea sp Spruce	10	1.8	2	Dead	P	R	R	RCD		
93	Picea pungens 'Gauca' Colorado Blue Spruce	14	2.4	4	Fair	P	P	R	RD		
94	Cedrela tomentosa var. nemis Honey Locust (Thornless)	28	2.4	8	Good	P	P	R	RD		
95	Cedrela tomentosa var. nemis Honey Locust (Thornless)	28	2.4	10	Good	P	P	R	RD		
96	Cedrela tomentosa var. nemis Honey Locust (Thornless)	26	2.4	18	Good	P	P	R	RD		
97	Cedrela tomentosa var. nemis Honey Locust (Thornless)	31	2.4	10	Good	P	P	R	RD		
98	Juglans nigra Black Walnut	23	2.4	7	Fair	P	P	R	RD		
99	Ailanthus altissima Tree Of Heaven	31	2.4	8	Fair	P	P	R	RD		
100	Acer platanoides Norway Maple	47	3.0	12	Fair	P	P	R	RD	Root damage (moderate); Crown dieback (minor)	

Private (On Site) Trees	83
Private (Off Site) Trees	7
Municipal Trees	10
Shared Trees	0
Subtotal	100
Preserve Tree Based on Health & Structure	87
Remove Tree Based on Health & Structure	13
Subtotal	100
Preserve Tree Based on Development Impacts	8
Remove Tree Based on Development Impacts	92
Subtotal	100
Final Recommendation: Preserve (P)	8
Final Recommendation: Remove due to Condition (RC)	0
Final Recommendation: Remove due to Development (RD)	79
Final Recommendation: Remove due to Condition and Development (RCD)	13
Subtotal	100

1. DBH (Diameter at breast height): Measurement of tree stem diameter at 1.4 meters above ground.
2. - Denotes Estimated
3. || Denotes Multiple Stems

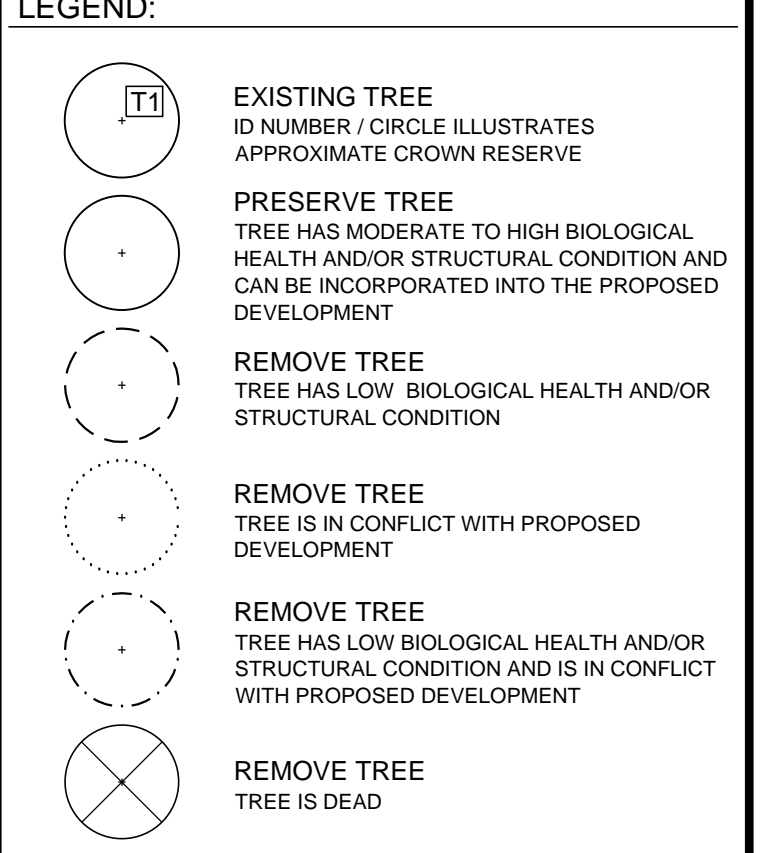
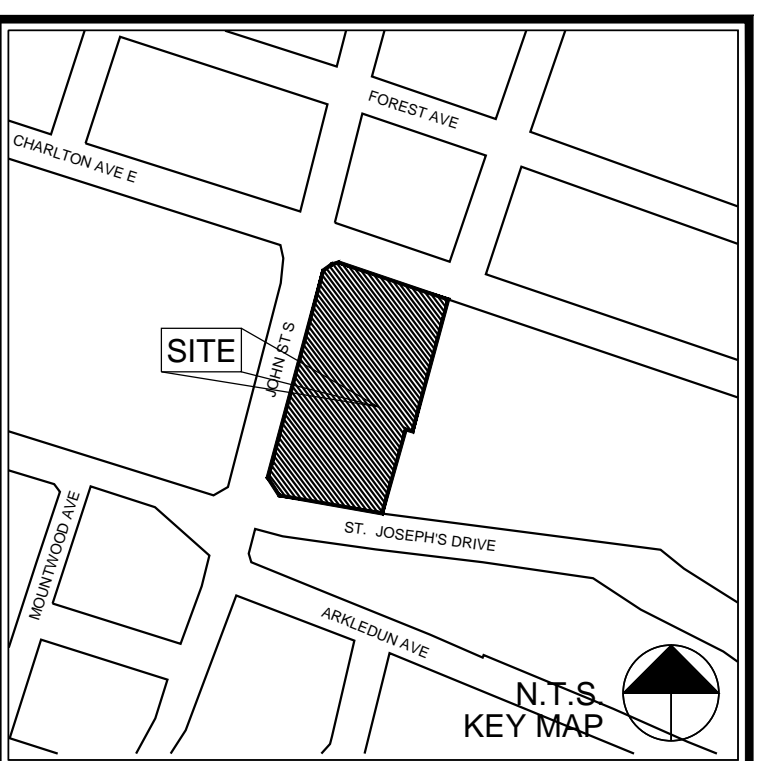

INFORMATION SOURCES

1. Topo Survey dated July 23, 2013 prepared by Ashenhurst Nouwens Limited. Tel 905.529.6316
2. Concept Plan dated August 3, 2017 prepared by Urban Solutions Inc. Tel. 905.546.1087
3. Tree Information collected by About & Associates on August 21, 2017.

No.	Description	By	Date
1	FIRST SUBMISSION OF TPP	JD	15 DEC-17

REVISIONS: All previous issues of this drawing are superseded

About & Associates Inc.
Consulting Arborists • Ecologists • Landscape Architects
190 Niclén Road, Guelph, Ontario, Canada L1H 7J5
1.519.822.6839 • F.519.822.4052 • info@aboutg.com • www.aboutg.com

TREE PRESERVATION TABLE

Project: 299-307 JOHN STREET SOUTH & 97 ST. JOSEPH DRIVE
CITY OF HAMILTON CLIENT

Date: DECEMBER 2017
Project: AA17-114A
Scale: NTS
Designer: JD
Drawn: NH
Checked: JD

TPP2